

## Sleeve anchor FSA-S

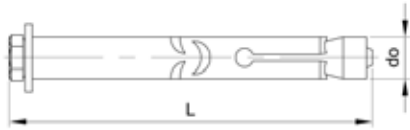

### Technical data

Type	FSA 8/15 S	FSA 8/40 S	FSA 8/65 S	FSA 10/10 S	FSA 10/35 S	FSA 10/60 S	FSA 12/10 S	FSA 12/25 S	FSA 12/50 S
$d_o$	8	8	8	10	10	10	12	12	12
L	59	84	109	60	86	110	70	85	110
$t_{fix}$	15	40	65	10	35	60	10	25	50
$h_{ef}$	35	35	35	40	40	40	50	50	50
Min. $t_d$	65	90	115	65	90	115	75	90	115
Allowable load in kN									
Concrete $\geq$ C20/25	5,2	5,2	5,2	12,9	12,9	12,9	25,7	25,7	25,7

- $d_o$  = Nominal diameter of drill bit
- $t_{fix}$  = Grip range
- $h_{ef}$  = Effective anchorage depth
- Min.  $t_d$  = Recommended drilling depth
- The allowable load is valid for one single anchor, at cracked concrete (tensile zone) with concrete class  $\geq$  C20/25.

### Assembly sequence

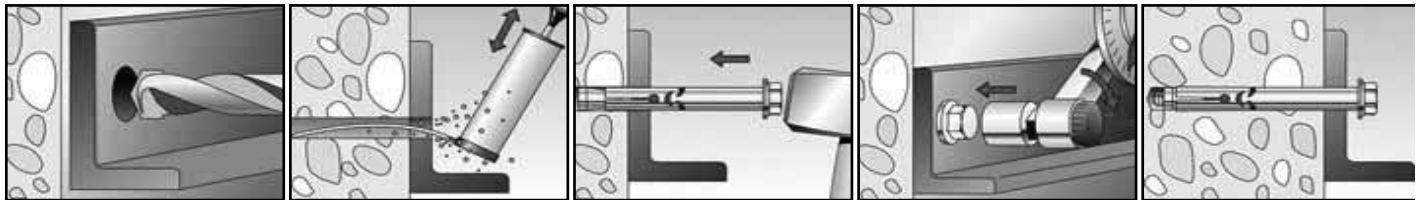

### 63226 FISCHER Sleeve anchor FSA-S

N03A

Thread: Metric thread  
 Material: Steel  
 Surface treatment: Zinc plated  
 Packaging: Standard



8

Type	☒	Art.number	Type	☒	Art.number	Type	☒	Art.number
FSA 8/15 S	50	<a href="#">63226.080.015</a>	FSA 10/10 S	20	<a href="#">63226.100.010</a>	FSA 12/10 S	20	<a href="#">63226.120.010</a>
FSA 8/40 S	50	<a href="#">63226.080.040</a>	FSA 10/35 S	20	<a href="#">63226.100.035</a>	FSA 12/25 S	20	<a href="#">63226.120.025</a>
FSA 8/65 S	50	<a href="#">63226.080.065</a>	FSA 10/60 S	20	<a href="#">63226.100.060</a>	FSA 12/50 S	20	<a href="#">63226.120.050</a>